

## Install a New Faucet

Today's faucets last longer and are more durable than those that were made years ago. And on top of all that, the washer-less designs of modern faucets often have fewer leaks and repairs. Here are some pointers on how to choose a faucet that's right for you.

### Types of faucets:

- ✧ There are two main faucet types commonly used in homes.
  - ✧ A **compression faucet** is given its name because of its handle that gives out water pressure by twisting on and off.
    - ✧ It's usually seen in outdoor faucets, washing machine hookups, and dual-handled sink fixtures.
  - ✧ The **mixing faucet** is the more modern of the two.
    - ✧ This kind of faucet has a lever or a knob that controls water flow and temperature.
    - ✧ This type of faucet is much more durable than a compression faucet, so it's more commonly used.
    - ✧ It's often seen in sinks, bathtubs, showers, and wash basins.

### Faucet variations:

- ✧ If the new faucet your buying doesn't have supply tubing, buy two supply tubes that are either braided steel or vinyl mesh.
- ✧ These will be attached to the faucet.
- ✧ You could also buy BP plastic or chromed copper for supply tubing, or simply buy a faucet that comes with copper supply tubes already attached.

### Checklist:

- Penetrating oil
- Basin wrench or channel-type pliers
- Putty knife
- Caulk gun
- Adjustable wrenches
- Faucet of choice (including sink sprayer)
- Silicone caulk or plumber's putty

### Remove old faucet

#### One: Remove coupling nuts.

- First, turn off the water.
- Using penetrating oil, spray the tailpiece mounting nuts and coupling nuts to being to loosen them so that its easier to detach.
- Remove the coupling nuts with a basic wrench or with channel-type pliers.

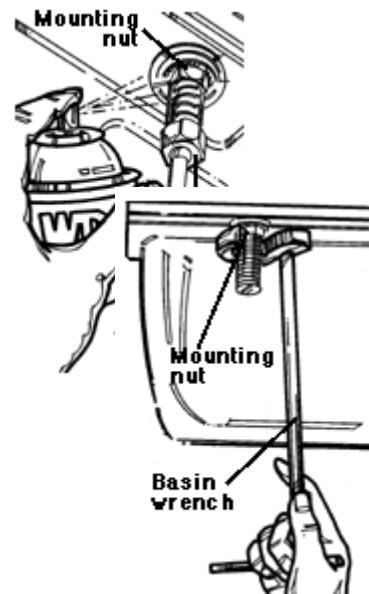

### Two: Unscrew the tailpiece.

- Using your basic wrench or channel-type pliers, unscrew the tailpiece mounting nuts.
- Remove the faucet.

### Three: Clean the surface.

- After removing the faucet, scrape away all of the old putty from the surface of the sink using a putty knife.

## Install new faucet with separate supply tubing

### One: Insert the faucet.

- Place the new faucet into the sink's holes.
- With either silicone caulk or plumber's putty, place a bead  $\frac{1}{4}$ -inch thick to the base of the faucet.
- Attach the faucet to the sink, being careful that the base is parallel to the back of the sink.
- Press the faucet firmly onto the sink so that it is sealed tightly.
- Wipe excess caulk from the surface of the faucet afterwards.

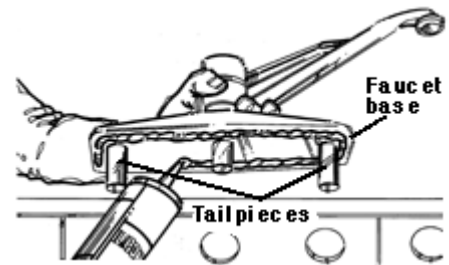

### Two: Tighten the nuts.

- Connect the metal friction washers and the mounting nuts to the tailpiece, again using a basic wrench or a pair of channel-type pliers.



### Three: Attach the tubing.

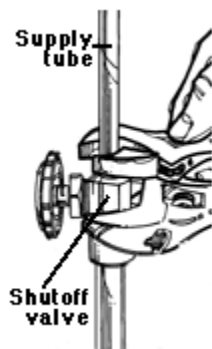

- Attach the supply tubes to the tailpiece, and use the basin wrench or channel-type pliers to tighten the coupling nuts.

### Four: Connect the water source.

- When the supply tubing is attached to the sink, connect it to the water source.
- Connect it at the shutoff valves using compression

fittings.

- Tighten the nuts by hand, then tighten the nuts  $\frac{1}{4}$  of a turn using an adjustable wrench.
- This will ensure that the nuts are not on too tight.



When you are tightening the supply tubing, it's a good idea to hold the valve with another wrench as to prevent it from turning out of place.

## **Install new faucet with pre-attached tubing**

### **One: Install the faucet.**

- Follow the instructions given for the [installation of a new faucet with separate supply tubing](#).
  - Simply leave out step three, seeing as the tubing is pre-attached.

### **Four: Connect the supply tubing.**

- Now, using a basin wrench or a pair of channel-type pliers, connect the pre-attached supply tubes to the shutoff valves.
- The red tubing connects to the hot water source, and the tubing labeled blue connects to the cold water source.

## **Attach a sink sprayer**

### **One: Insert the sprayer.**

- Using your plumber's putty or silicone caulk, apply a  $\frac{1}{4}$  inch thick bead to the base of the sprayer.
- Insert the end of the sprayer hose into the sink opening, and press into place.

### **Two: Attach mounting nut.**

- Screw the mounting nut onto the end of the sprayer after placing a washer over the tailpiece.
- Using a basin wrench or a pair of channel-type pliers, tighten the mounting nut.
- Remove extra putty from the base of the sprayer.

### **Three: Attach the hose to the faucet.**

- Connect the hose to the hose nipple at the bottom of the faucet.
- Tighten the screw  $\frac{1}{4}$  of a turn using a basin wrench or a pair of channel-type pliers.